



Established 1958

Float & Thermostatic Steam Traps Series TA-FTH (High Capacity)

Operation

Tunstall Associates, Inc. produces a full line of Float & Thermostatic Steam Traps containing a float valve mechanism which modulates to discharge condensate continuously, while non-condensable gases are released by a separate internal balanced pressure thermostatic air vent (The Tunstall Capsule®).

The “FTH” series traps are designed for use in systems that produce an exceptionally large amount of condensate (625 to 24,000 lbs. of condensate per hour). Two sizes (1-1/2" & 2") available for low, medium and high pressure applications with a “H” pattern piping connection for maximum installation flexibility.

All Tunstall float and thermostatic traps can be serviced without disturbing system piping.

Features

- Rapid condensate removal.
- Stainless steel balanced pressure thermostatic air vent (Tunstall Capsule®).
- All stainless steel internal components
- Variety of piping connections.
- Designed to withstand water hammer & high load demands.
- Designed for In-line repair.
- Made in the U.S.A.

Construction

Tunstall float and thermostatic traps feature all stainless steel interiors, heavy duty trap housings, easy access to internal parts and convenient piping connections.



Materials of Construction

Body & Cover	Cast Iron-ASTMA 126CI B
Valve Head	Stainless Steel
Valve Seat	Stainless Steel
Valve Seat Gasket	Non-Asbestos
Float	Stainless Steel
Bracket & Lever Assembly	Stainless Steel
Thermostatic Air Vent	Tunstall Capsule® Stainless Steel
Cover Bolts	Carbon Steel Grade 5
Cover Gasket	Non-Asbestos
Draining Plug	Steel (Grade 2)

Tunstall Associates, Inc. • 118 Exchange Street • Chicopee, MA 01013

Phone (413) 594-8695 • Fax (413) 598-8109

www.Tunstall-Inc.com

© September 2000

FLOAT & THERMOSTATIC STEAM TRAPS SERIES "TA-FTH"

Engineering Specifications

CAPACITIES

lbs. Condensate per hour

Model	Size NPT	PSIG Orifice	DIFFERENTIAL PRESSURE (PSI)														
			1/4	1/2	1	2	5	10	15	20	25	30	40	50	75	100	125
TA-FTH6-15	1½"	1.032	6400	7500	9300	13000	16500	21000	24000								
TA-FTH8-15	2"	1.032	6400	7500	9300	13000	16500	21000	24000								
TA-FTH6-30	1½"	.762	2575	4500	5650	8750	11800	14500	17500	19500	20600	21600					
TA-FTH8-30	2"	.762	2575	4500	5650	8750	11800	14500	17500	19500	20600	21600					
TA-FTH6-75	1½"	.500	1500	2750	3500	4750	6300	7750	9250	10500	12250	12500	13500	14500	17000		
TA-FTH8-75	2"	.500	1500	2750	3500	4750	6300	7750	9250	10500	12250	12500	13500	14500	17000		
TA-FTH6-125	1½"	.328	625	825	1100	1550	2100	3000	3500	3900	4200	4400	5000	5500	6750	7750	8700
TA-FTH8-125	2"	.328	625	825	1100	1550	2100	3000	3500	3900	4200	4400	5000	5500	6750	7750	8700

ALL 1½" & 2" SERIES "TA-FTH" F&T TRAPS

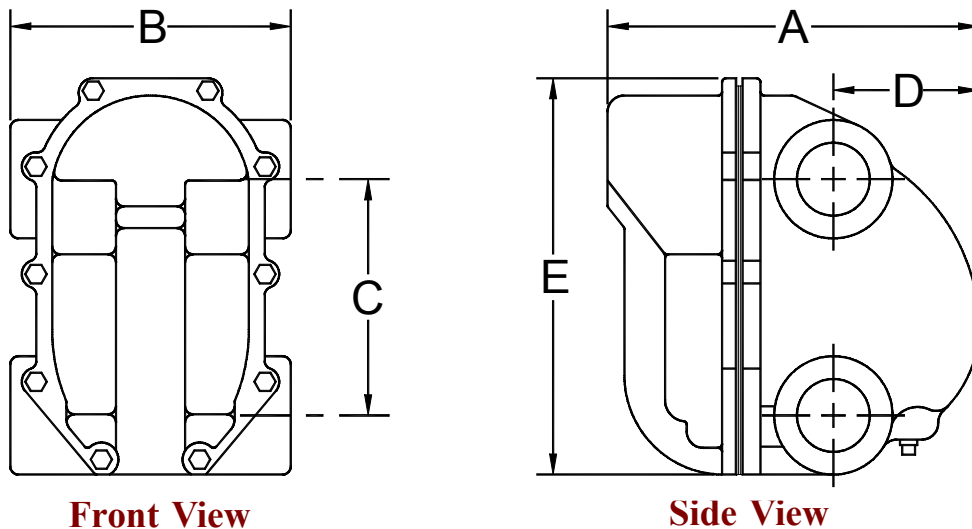

Front View

Side View

Model	Size	DIMENSIONS (Inches)					Weight (lbs.)
		A	B	C	D	E	
TA-FTH6-15	1½"	11.00	8.50	7.00	4.25	12.00	48
TA-FTH8-15	2"	11.00	8.50	7.00	4.25	12.00	48
TA-FTH6-30	1½"	11.00	8.50	7.00	4.25	12.00	48
TA-FTH8-30	2"	11.00	8.50	7.00	4.25	12.00	48
TA-FTH6-75	1½"	11.00	8.50	7.00	4.25	12.00	48
TA-FTH8-75	2"	11.00	8.50	7.00	4.25	12.00	48
TA-FTH6-125	1½"	11.00	8.50	7.00	4.25	12.00	48
TA-FTH8-125	2"	11.00	8.50	7.00	4.25	12.00	48